

Santa Cruz

Radio Face Quick Start Guide

What's in the Box

Santa Cruz Face

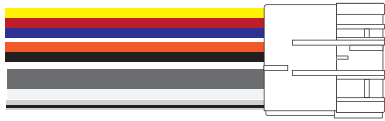

661 GM Adapter Harness



662 Antenna Adapter

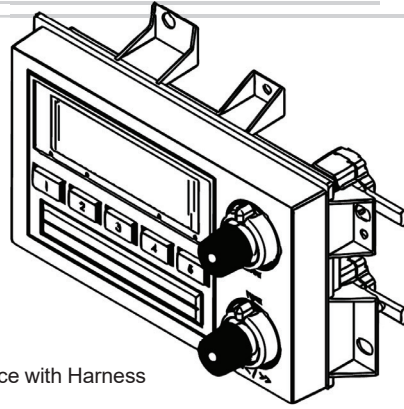

Radio Face with Harness

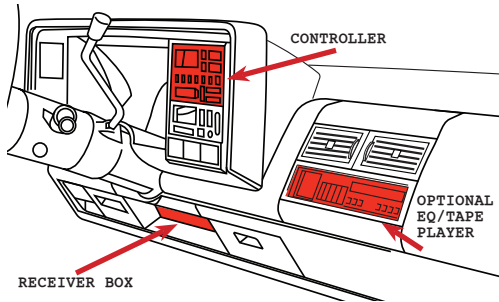

The factory radio in this vehicle is a two or three-part system consisting of: a radio controller mounted in the upper-right side of the dash, an optional EQ or tape player located in the center of the lower dash and the radio receiver box located under the dash just above the gas pedal area.

Before installing, disconnect the vehicle's negative battery terminal.

Steps 1-2 Unplug The Factory Radio Receiver

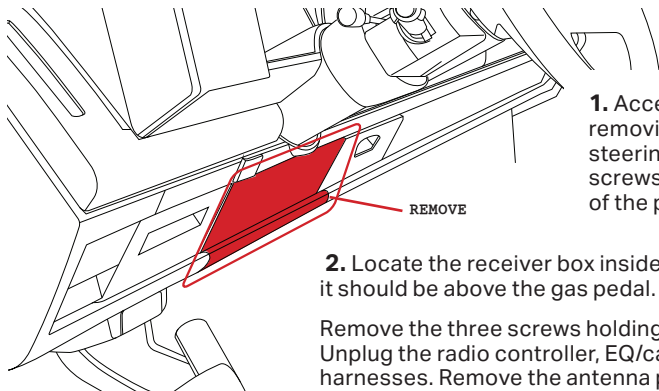

1. Access the radio receiver box by removing the panel just below the steering column. Remove the two screws located at the bottom corners of the panel, then remove the panel.

2. Locate the receiver box inside where panel was just removed, it should be above the gas pedal.

Remove the three screws holding the receiver box in place. Unplug the radio controller, EQ/cassette unit and main harnesses. Remove the antenna plug, and then the receiver box.

Step 3 Remove the Factory Radio Controller

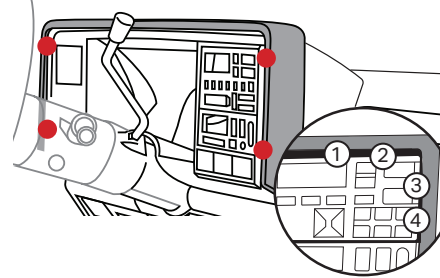

Locate and Remove the 4 screws (red) holding the trim bezel (grey), then carefully remove the trim from around the gauges.

Next carefully remove screws 1-4 holding the controller in place, then remove the controller from the dash.

Step 4 Routing the Santa Cruz Harness

Route the Santa Cruz Face harness through the dash opening, guiding it toward the motor mounting location underneath the dash, where the OEM receiver was originally removed.

Ensure you leave enough extra cable length so that the face harness can easily be plugged into the radio motor.

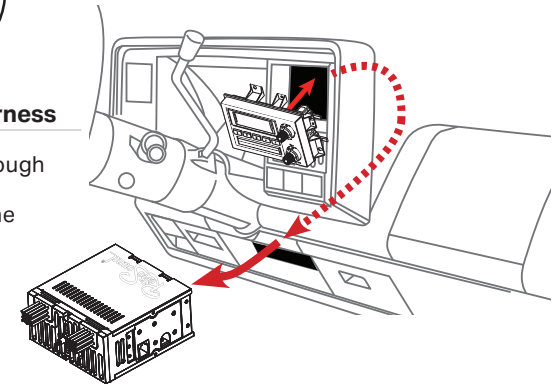

Step 5 Connecting the Santa Cruz radio face to the RetroSound® radio motor.

To replace the pre-installed motor cable with the Santa Cruz radio face cable, you'll first need to unplug the existing motor cable.

For easier access, remove the top cover of the radio body.

1. Remove the screw at the back of the motor (see diagram on the right).
2. Lift the top cover.
3. Unplug the pre-installed ribbon cable from the motor.
4. Connect the Santa Cruz radio face cable to the motor in place of the original.

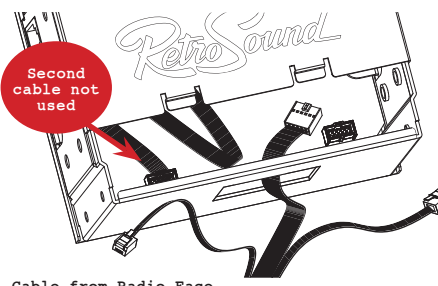
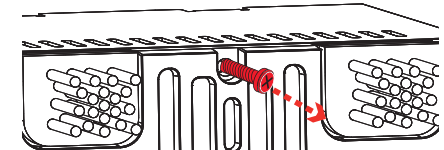

Cable from Radio Face

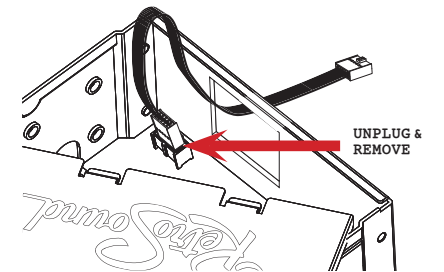

Make sure the new cable is properly seated before reassembling the top cover.



Modern Sound For Your Classic

Steps 6-7 Connecting Shaft Plugs & Motor Harness

6. Connect each shaft plug into the sides of the radio body.

While looking down at the radio body with the motor cables coming out the back, the imprinted "RetroSound" will be on the top of the radio body chassis.

The shaft plug cable marked "R" plugs into the input to the right of "RetroSound" on the radio body, and the shaft plug cable marked "L" plugs into the left side.

7. Connect the Motor harness that came in the motor box of your Retrosound radio to the adapter harness supplied with your radio face.

Connect color to matching color on each connector. Our radios do not use all the wires available on the adapter, any unused wires should be capped off and taped away. Then plug the harness into the factory harness and into the Retrosound Motor.

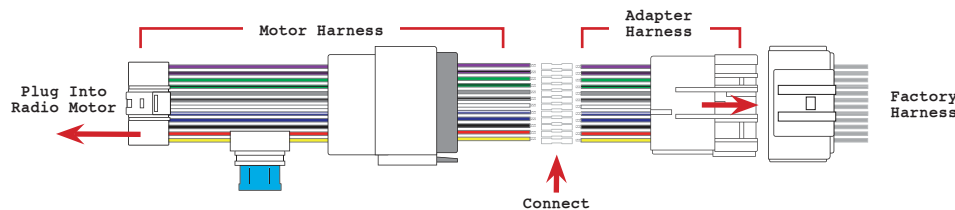
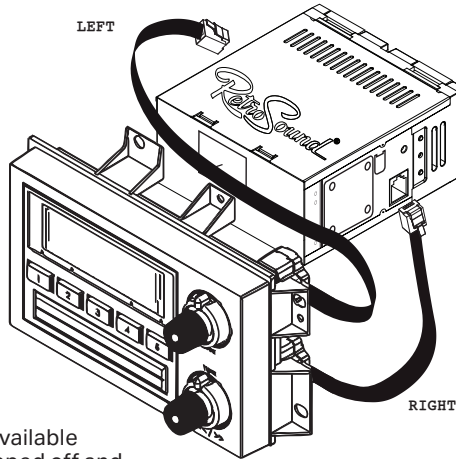

Refer to the Installation and Assembly Manual or visit our website for complete wiring instructions.

Steps 8-10 Final Assembly

8. Using the backstrap, mount your radio body into the receiver box location above the gas pedal.

9. Mount the Santa Cruz Radio Face into the controller's location. Reconnect the vehicle's battery and test the system to ensure everything is connected properly.

10. Replace the trim, bezel and lower dash panel to complete the installation.

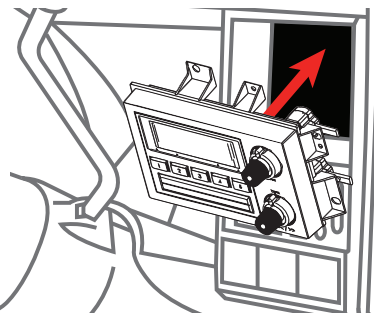

Control Layout

Radio Presets

Setting Radio Presets

To set a preset, tune to the station you want to set the preset to, and then press and hold the desired Preset Button(5) for two seconds.

Recalling Radio Presets

To recall a preset, simply press the Preset Button(5) your station was set to previously.

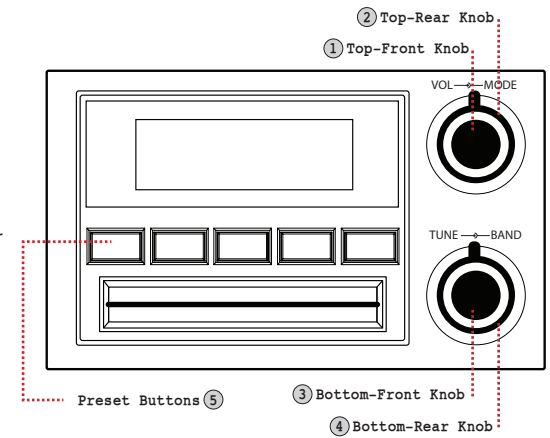

Basic Operation

Power On/Off

Press the Top-Front Knob(1) to power the unit on.
Press and hold the Top-Front Knob(1) to power the unit off.

Volume

Rotate the Top-Front Knob(1) to change the volume.

Changing Source Modes

Rotate the Top-Rear Knob(2) clockwise to cycle through the source modes.

Changing Radio Bands

Rotate the Bottom-Rear Knob(4) counter-clockwise to cycle through the radio bands.

Tune

Rotate the Bottom-Front Knob(3) to scroll through the stations.

Mute On/Off

Press the Bottom-Front Knob(3) to mute and unmute.

Equalizer (EQ)

Press the Top-Front Knob(1) to enter the Tone Control sub-menu. Press and release the Top-Front Knob(1) until you see the EQ setting you'd like to adjust. Rotate the Top-Front Knob(1) to adjust the setting. Press the Top-Front Knob(1) to move to the next item, and repeat to adjust each option. Let the unit time out to set.

Setting the Clock

Press and hold the Bottom-Front Knob(3) to enter the System Settings sub-menu. Rotate the Bottom-Front Knob(3) to cycle through the choices until you see CLK, then press the Bottom-Front Knob(3) to select. Rotate the Bottom-Front Knob(3) to adjust the hours. Then press the Bottom-Front Knob(3) again to move on to minutes. Rotate the Bottom-Front Knob(3) to adjust the minutes. Let the unit time out to set.

Display Color*

Press and hold the Bottom-Front Knob(3) to enter the System Settings sub-menu. Rotate the Bottom-Front Knob(3) to cycle through the choices until you see SCAN, then press the Bottom-Front Knob(3) to cycle through the colors. Let the unit time out to set.

Beep On/Off

Press and hold the Bottom-Front Knob(3) to enter the System Settings sub-menu. Rotate the Bottom-Front Knob(3) to cycle through the choices until you see BEEP ON/OFF, then press the Bottom-Front Knob(3) to choose between BEEP ON or BEEP OFF. Let the unit time out to set.

*Some features are not available on all radios.